

Cim 921

ALUMINIUM BUTTERFLY HANDLE Cim 310 - 312 - 314

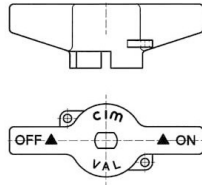

This article was made in compliance with the quality management requirements of ISO 9001 standard.
Accessory/original spare part for Cimberio products

It is guaranteed for 2 years.

Made of aluminium alloy in conformity with standard EN AB-46100.

TECHNICAL DRAWING

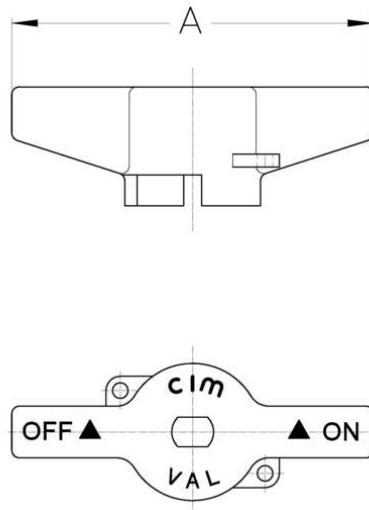

A	43	50	70	85	100
Grms.	8	23,5	33,5	57	83

TECHNICAL CHARACTERISTICS

A	43	50	70	85	100
Cim 310	-	1/4" - 3/8"	1/2"	3/4" - 1"	1"1/4 - 1"1/2 - 2"
Cim 312	1/4" - 3/8"	1/2"	3/4" - 1"	1"1/4	1"1/2 - 2"
Cim 314	1/4" - 3/8"	1/2"	3/4" - 1"	1"1/4	1"1/2 - 2"

REACH Regulation

According to article 33 of REACH Regulation, we inform you that the components made of bronze and brass alloys that are parts of the articles we supply, contain the lead (as alloy component) in a higher quantity of the limit of 0,1% in weight. Lead has been inserted in the list of SVHC substances nominated for the authorisation process, in the updating published by the European Chemical Agency ECHA on 27th June 2018. Lead has been introduced with the following information:

- Substance: Lead
- CAS: 7439-92-1
- EC: 231-100-4
- List: SVHC
- Data of Inclusion: 27th June 2018

Since lead is an element of the alloy, no exposure is expected and consequently, no further information is requested for the safe use of this product.

The list is available at the following link: <https://echa.europa.eu/it/candidate-list-table> and since it is a continuously updated list, we declare the constant monitoring about insertion of new substances and the prompt on time information to our customers in case such substances should be contained in the products we supply.

Make sure product materials and features are suitable for system scope and conform to the local regulations in force

OUR CERTIFICATIONS



